

Rolec EV Quantum

Clenergy EV Platform Onboarding Guide

- Download the Rolec EV Connect app for your device.

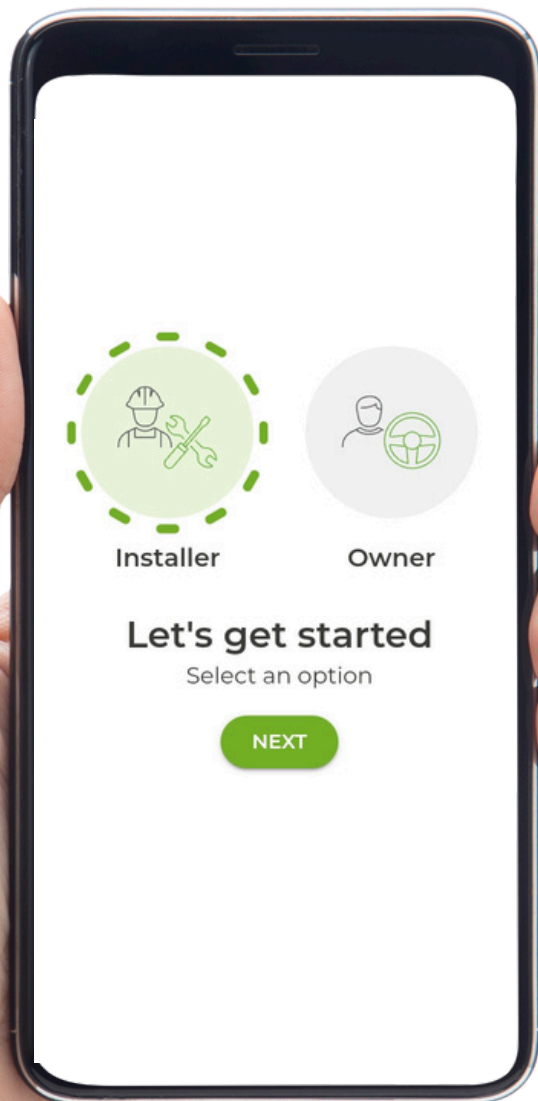

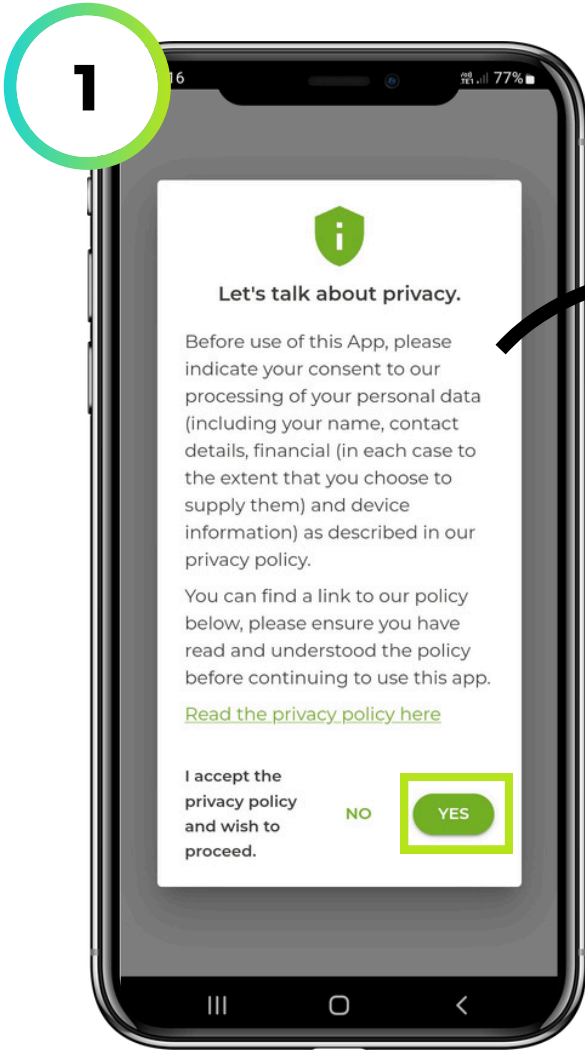

1. Once downloaded and installed on your device, open the Rolec EV Connect app then review and accept the privacy policy.

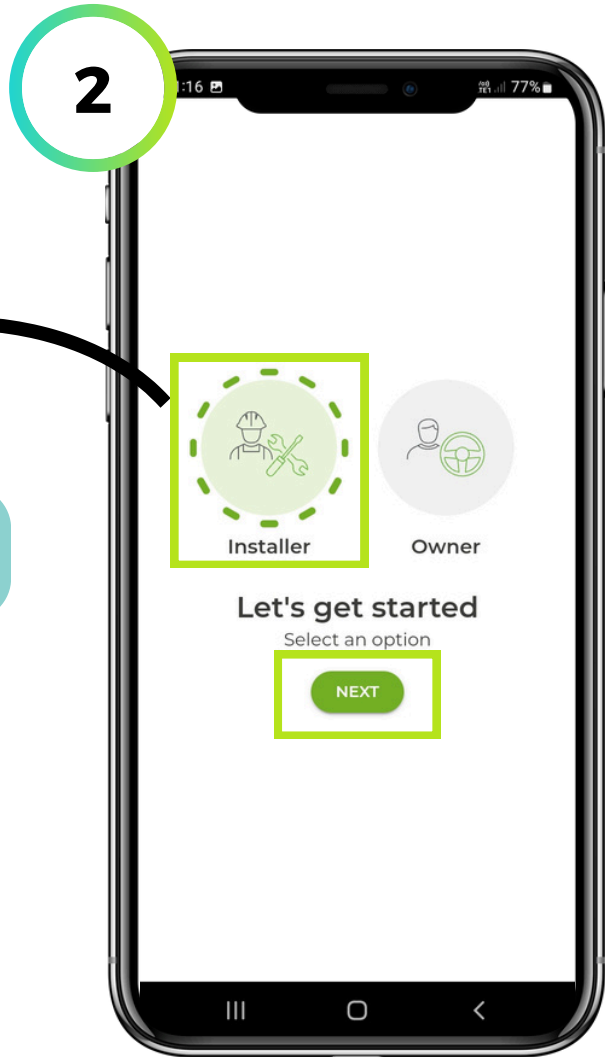

2. Select the Installer icon and NEXT to proceed.

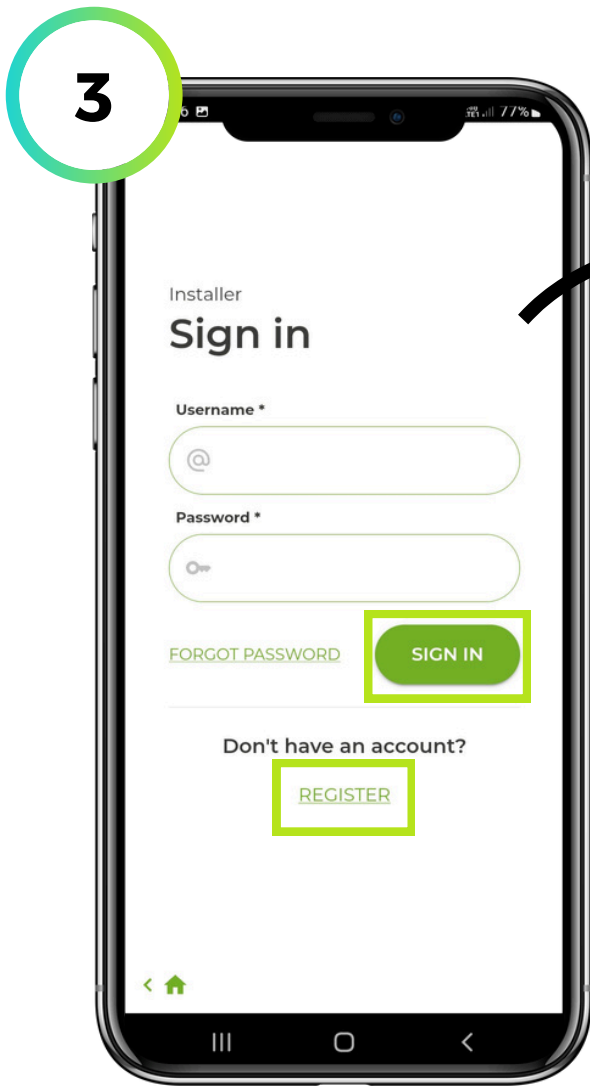

3. Register as an installer if you have not already done so then select SIGN IN.



4. Select NEW to add your installation to your projects.

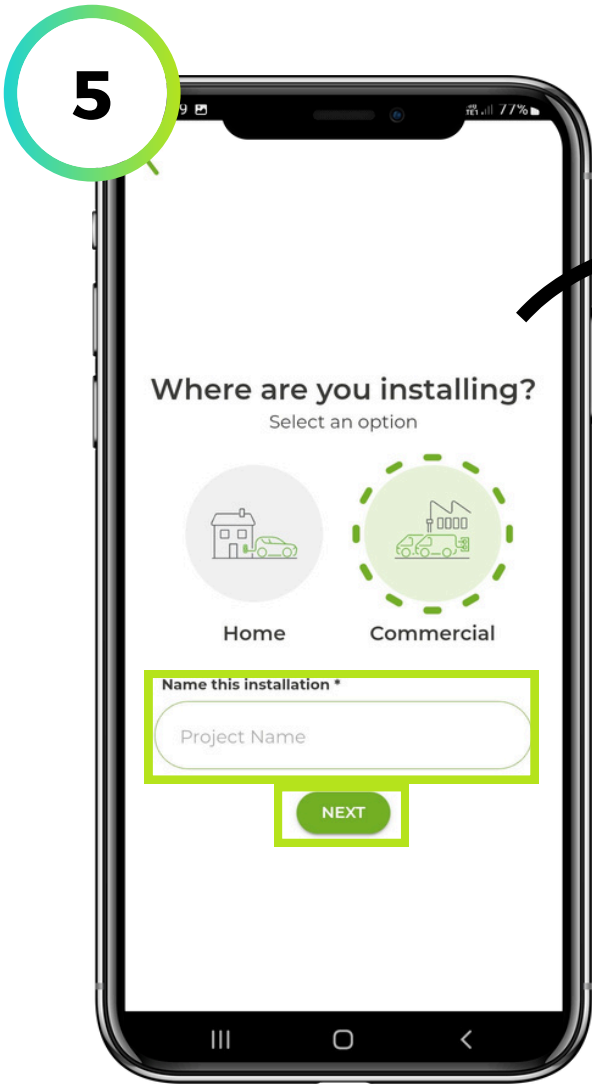

5. Select the relevant type of installation, enter the installation name and select NEXT to proceed.



6. Select your installation from the list displayed.

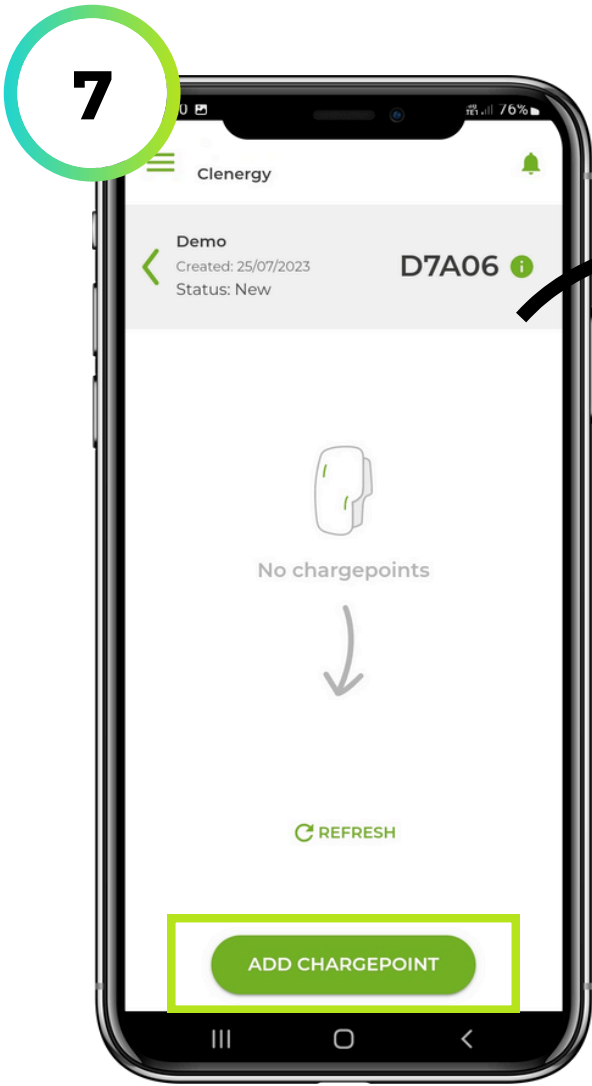

7. Select **ADD CHARGEPOINT** to proceed.

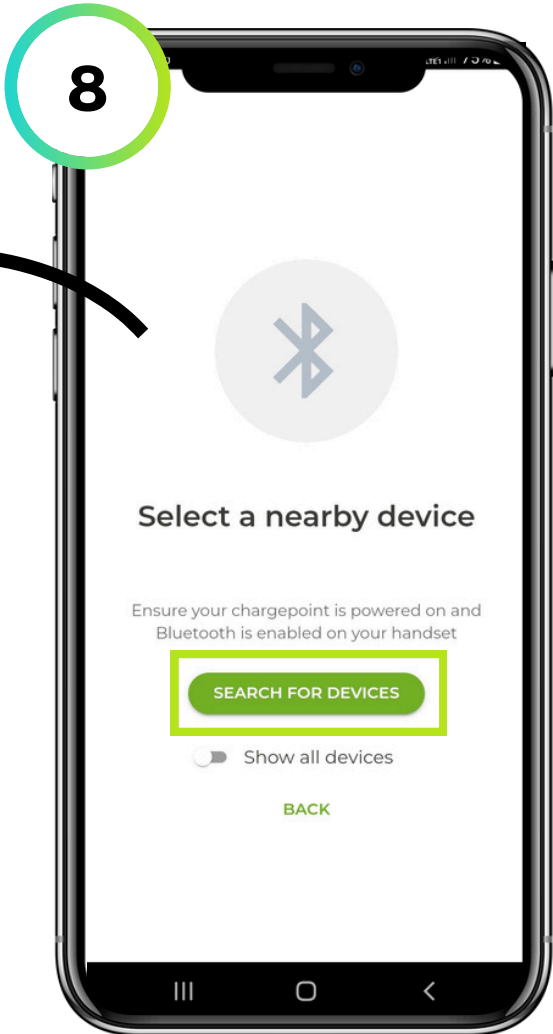

8. Select **SEARCH FOR DEVICES** to establish a bluetooth connection with the charge point.

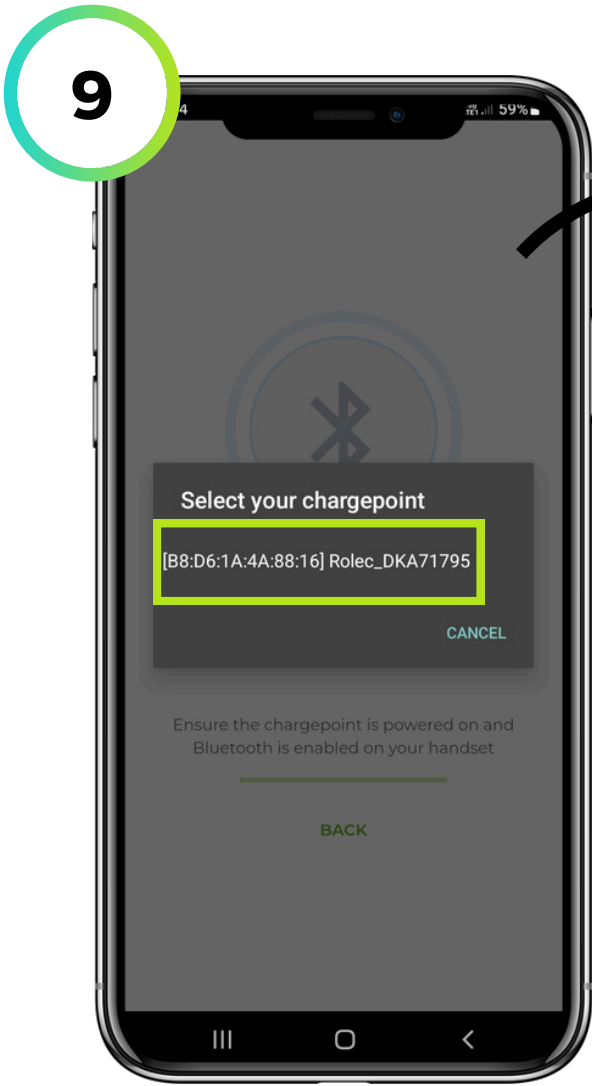

9. Select the relevant charge point from the list as identified by the serial number (more than one charge point may be displayed depending on your installation). Enter the password as located in the charge point documentation if prompted.

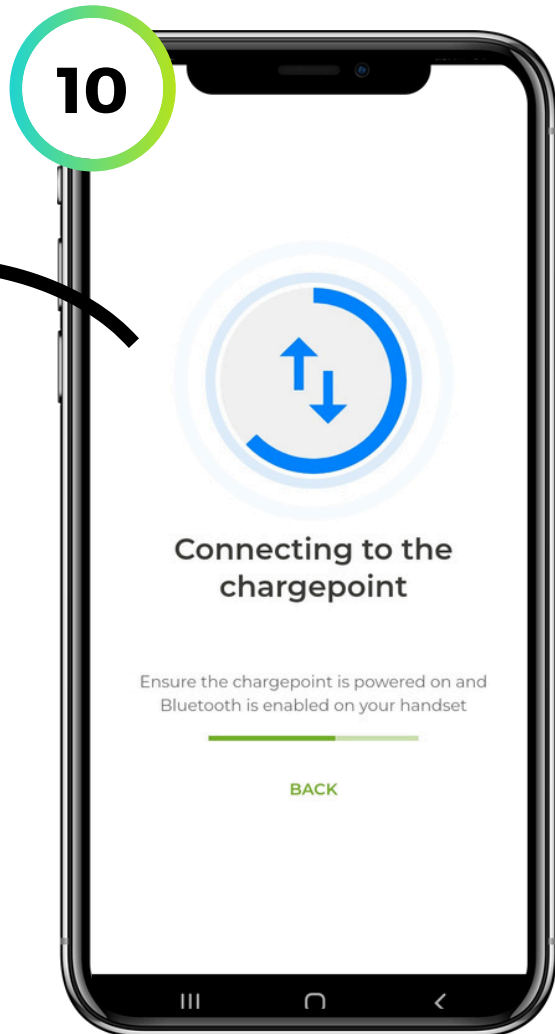

10. Your device will attempt to connect to the charge point.

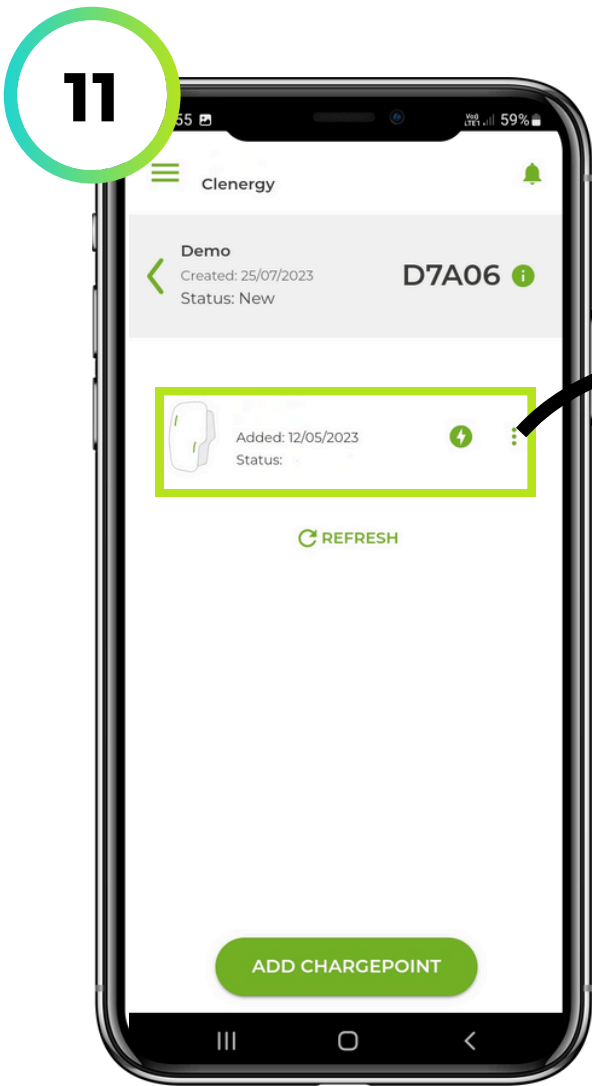

11

11. On the charge point main menu, select OCPP Server.

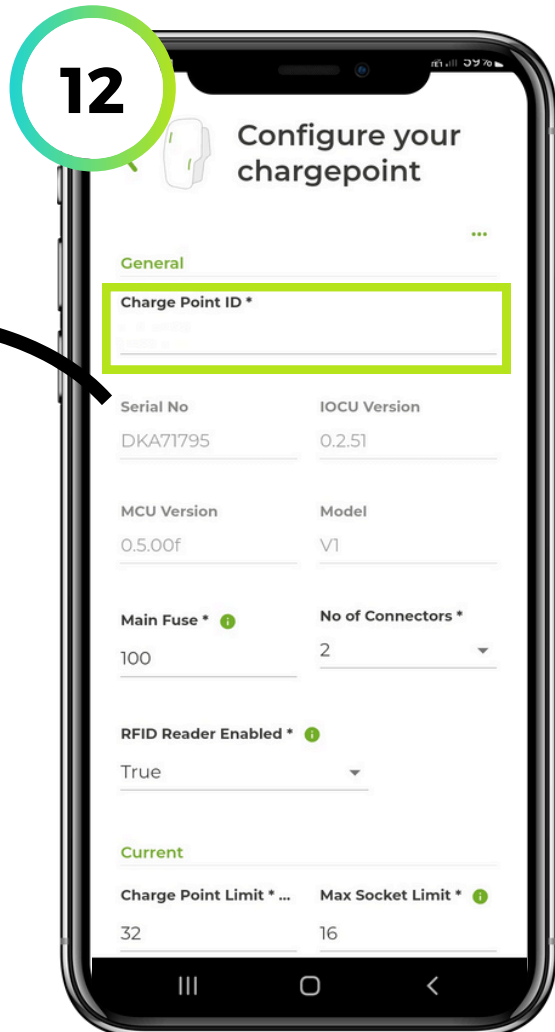

12

12. Enter the charge point serial number (as displayed with the product documentation) into the Charge Point ID field.

13

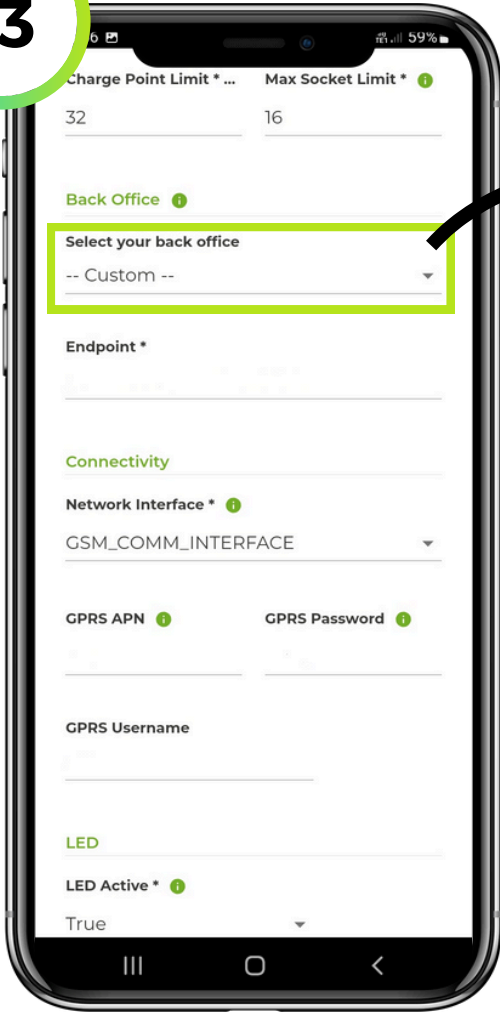

13. Scroll down to the Back Office section and select the Select your back office field.

14

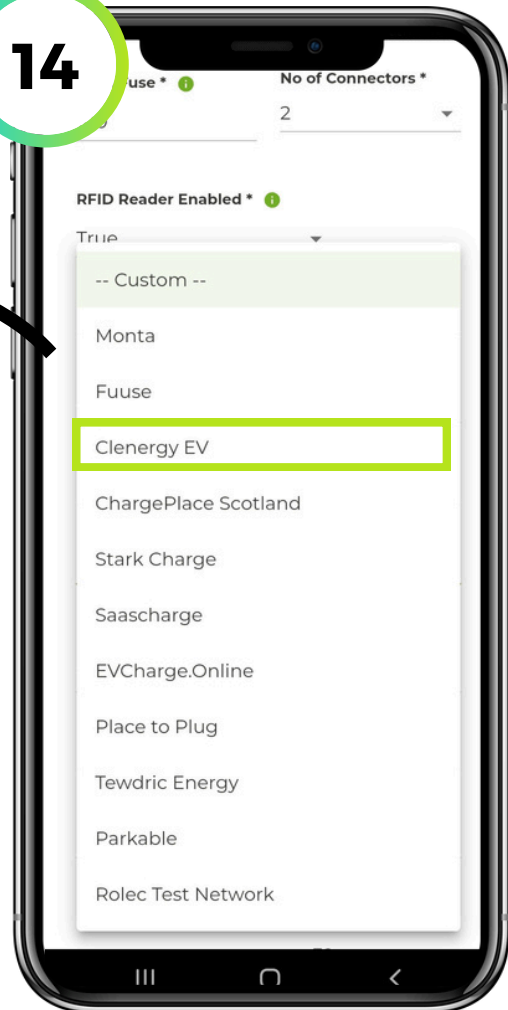

14. Select Clenergy EV from the drop-down menu.

15

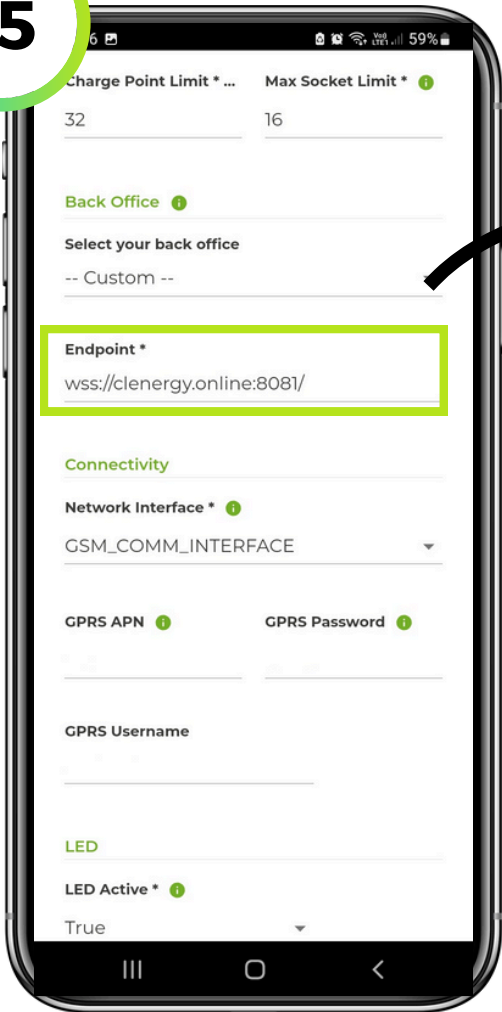

15. The Clenergy EV URL should now be displayed in the Endpoint field as displayed. If not, manually enter the following URL:
wss://clenergy.online:8081/

16

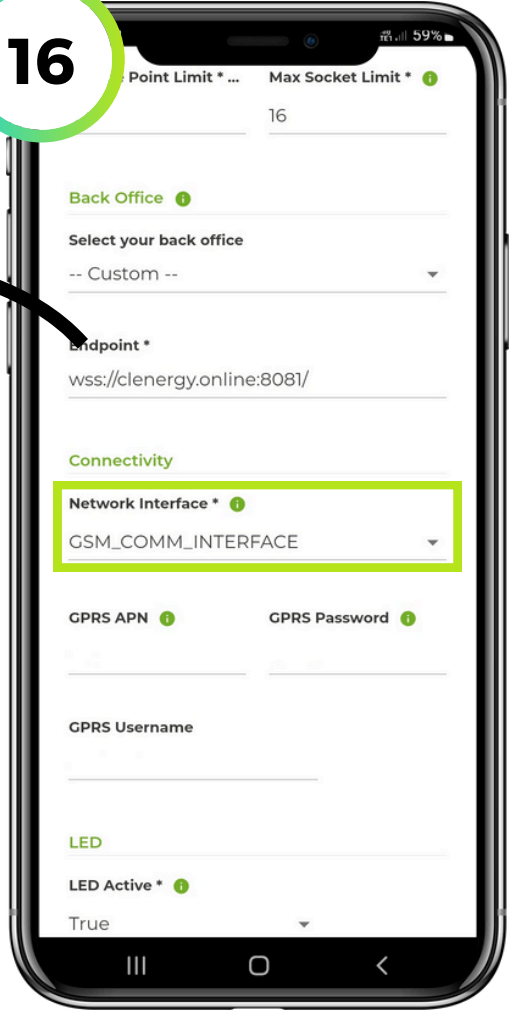

16. In the Connectivity section, select the Network Interface field.

17

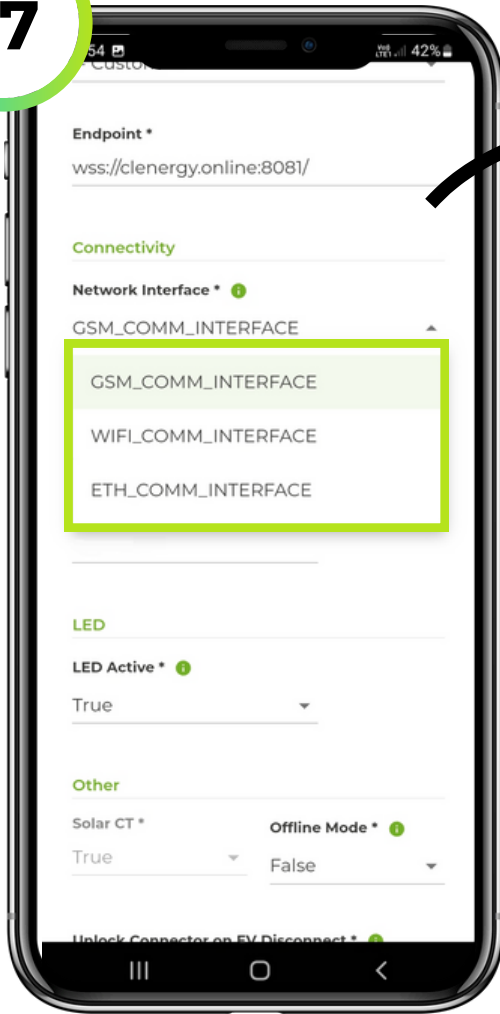

17. Select the relevant **network option** from the drop-down menu for your installation and enter the **required network credentials** to establish a connection.

Please note: Only one network connection type can be used at any one time.

18

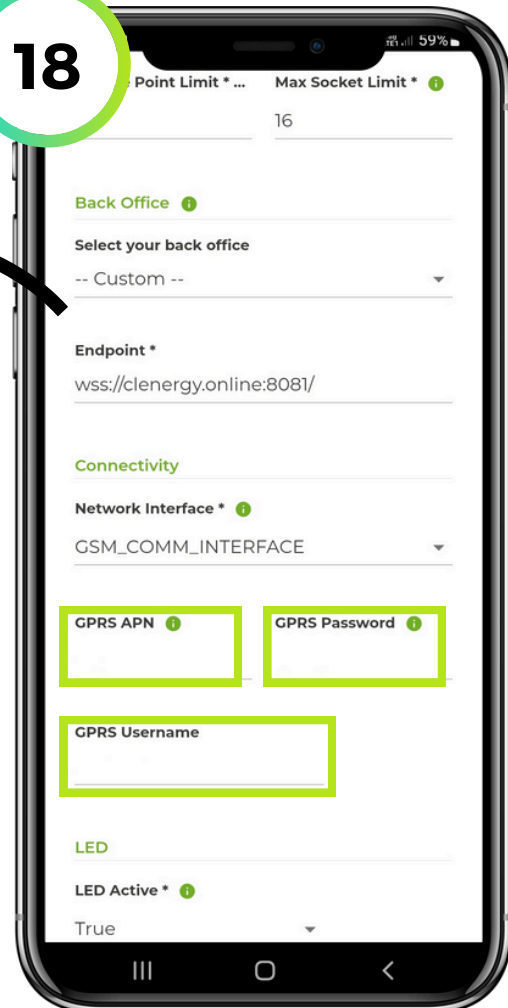

18. If connecting using a 4G/SIM network, enter **eapn1.net** in the GPRS APN field and **clenergy** in the GPRS password and GRPS Username fields.

19

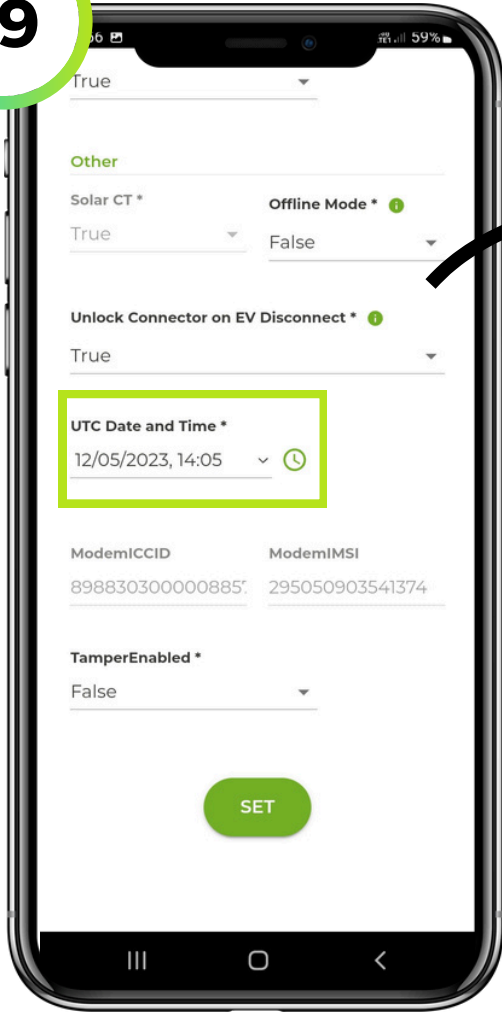

19. Configure all other options as required to suit your installation such as the date/time and electrical settings.

20

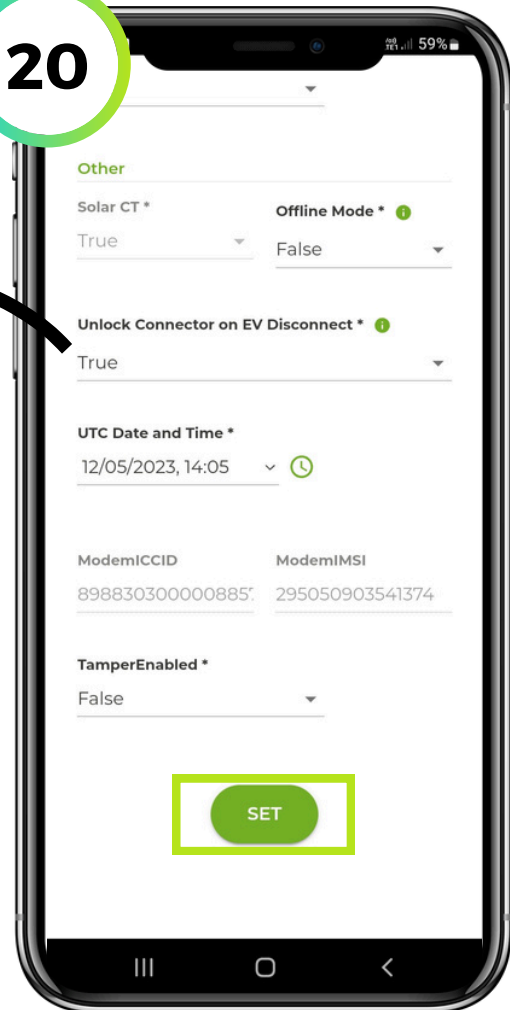

20. Select SET to complete the process.