

# Autel Sevadis Maxicharger

## Cleenergy EV Platform Onboarding Guide

- Download the **Autel Config app** for your device.
- **Please note:** Ensure you are **registered as an installer with Autel** and have received login details prior to attempting the onboarding process.

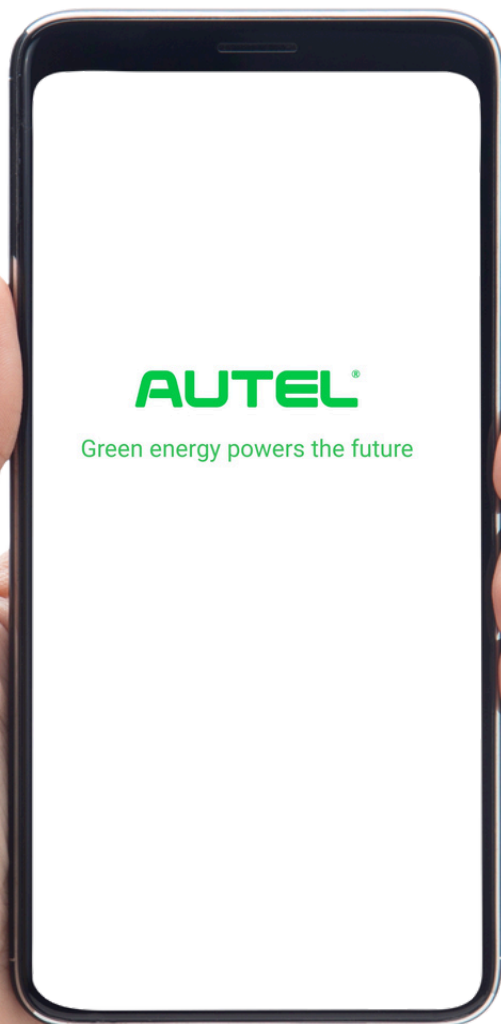

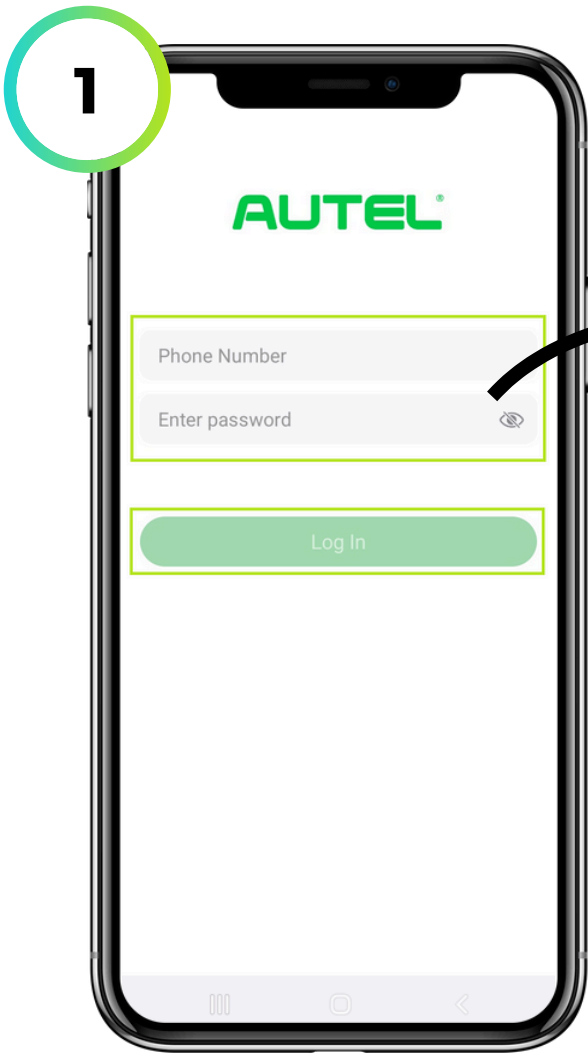

1. Once downloaded and installed, open the Autel Config app and log in using the Autel-supplied credentials.

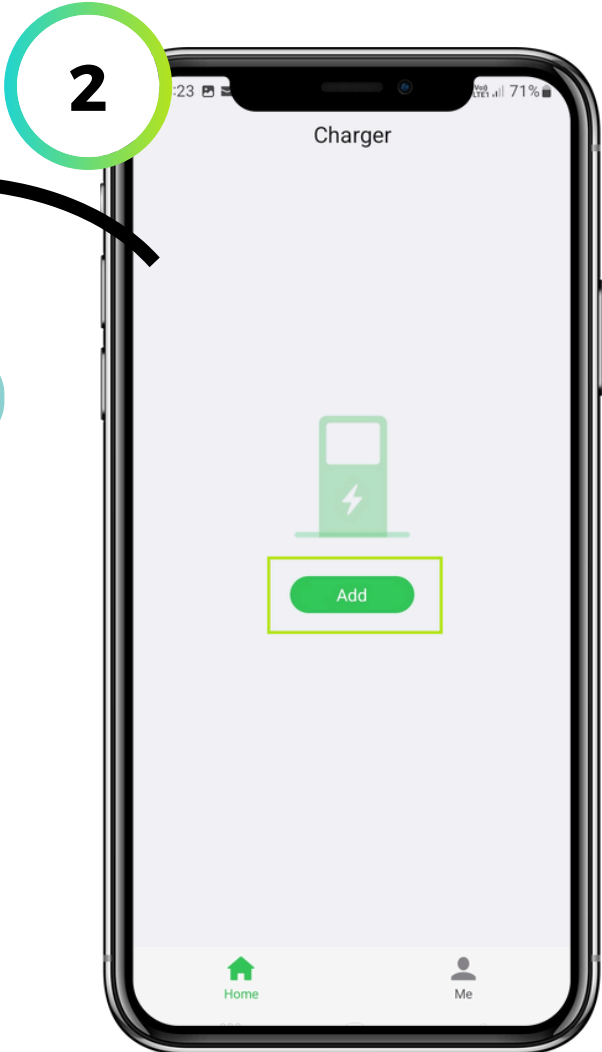

2. Select Add to proceed.

3

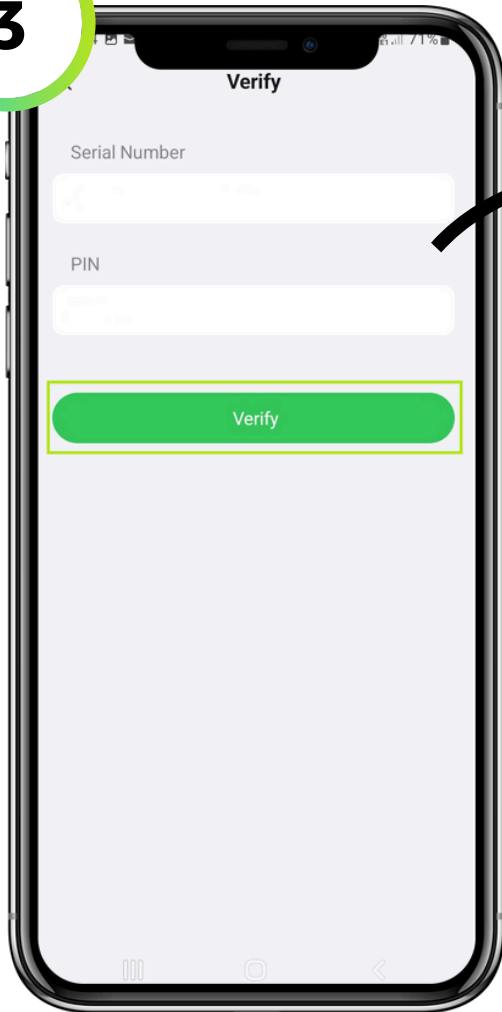

3. Scan the QR code located directly on the side of the charger or the code supplied with the charger's documentation.

Enter the PIN number as provided with the charger documents and select **Verify** to proceed.

4



4. Select your charger (identified by the serial number) and select **Connect via Bluetooth**.

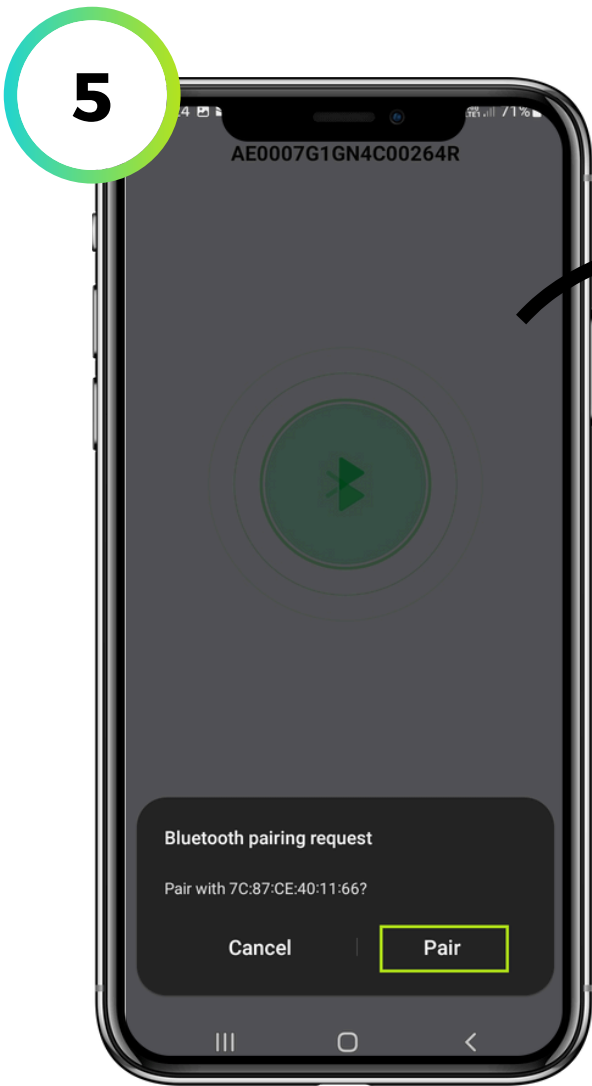

5. When prompted, select **Pair** to connect your device to the charger.

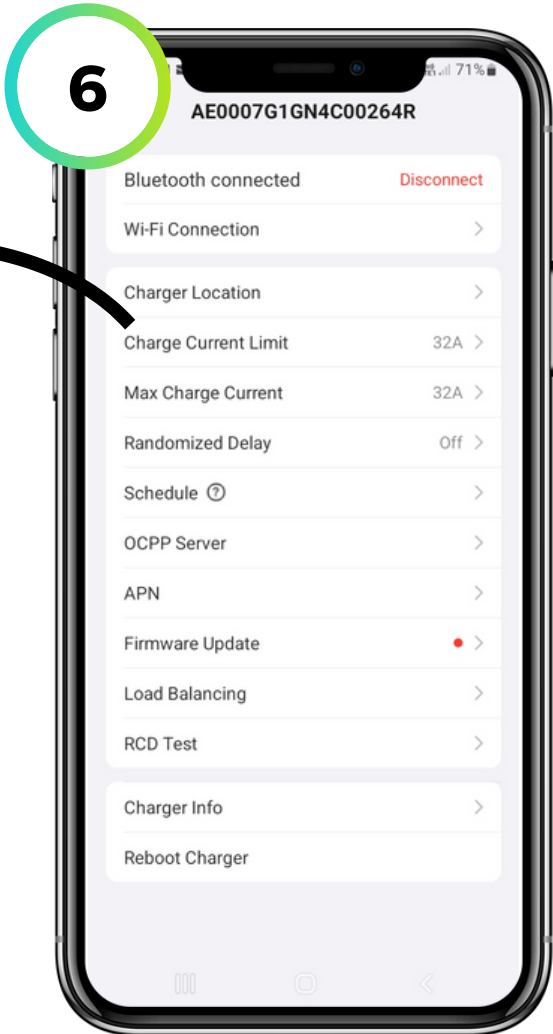

6. On the charge point main menu, **configure the network and electrical settings** as required by your installation by selecting the relevant options from the menu shown.

**Please note:** Only one network connection type should be used at a time.

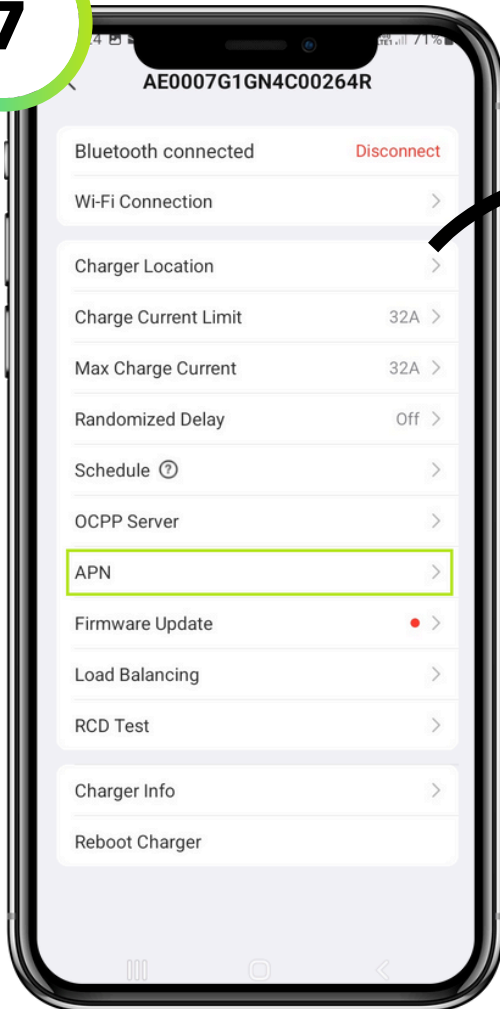
**7**

7. If establishing a network connection to Clenergy EV via a Clenergy EV Sim card, select APN from the menu. If not please skip to step 10.

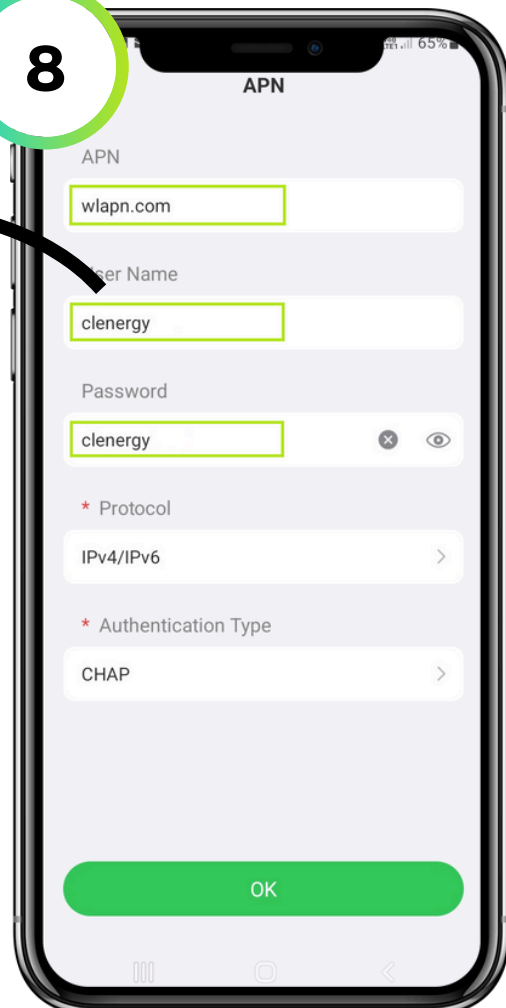
**8**

8. Enter **eapn1.net** into the APN field and **clenergy** into the User Name and Password fields respectively.

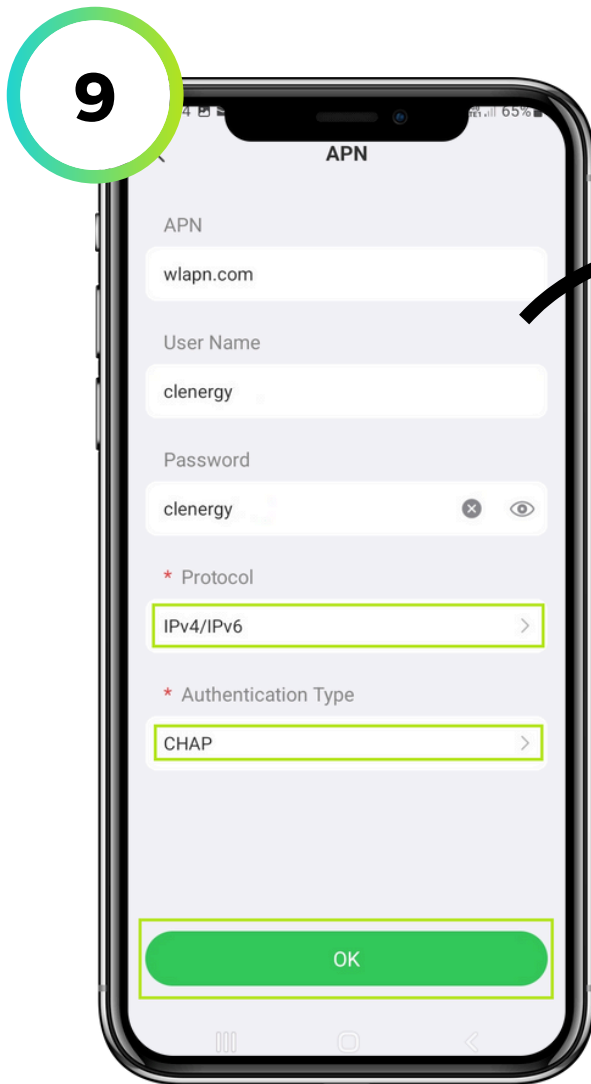

9. Select IPv4/IPv6 from the Protocol drop-down menu and PAP/CHAP from the Authentication Type menu.  
Select OK to proceed.

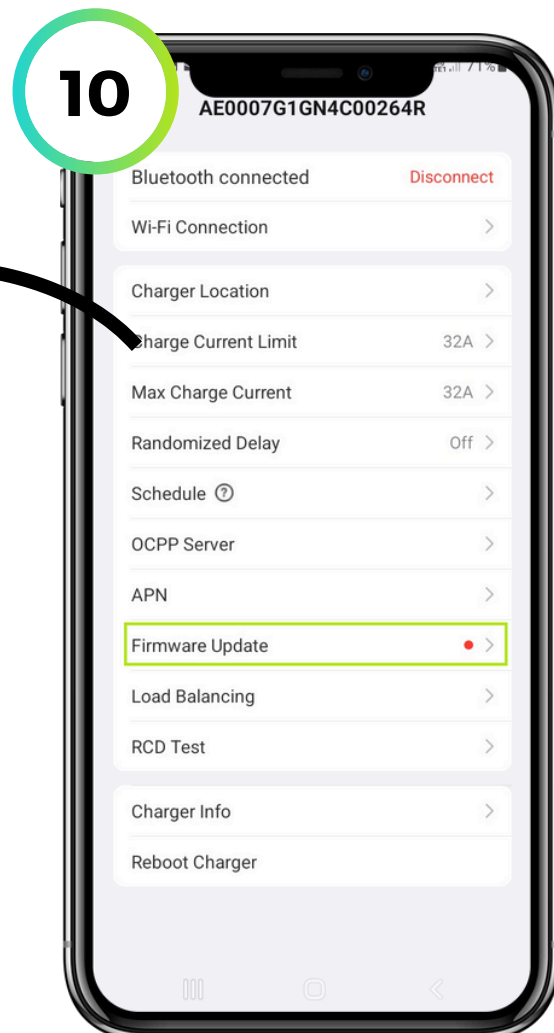

10. On the charge point main menu, update the Firmware if required (indicated by a red marker) and follow the on-screen instructions.

**Please note:** It is recommended to use a Wi-Fi/Hotspot connection to complete the firmware update or contact Autel to complete this process remotely.

11

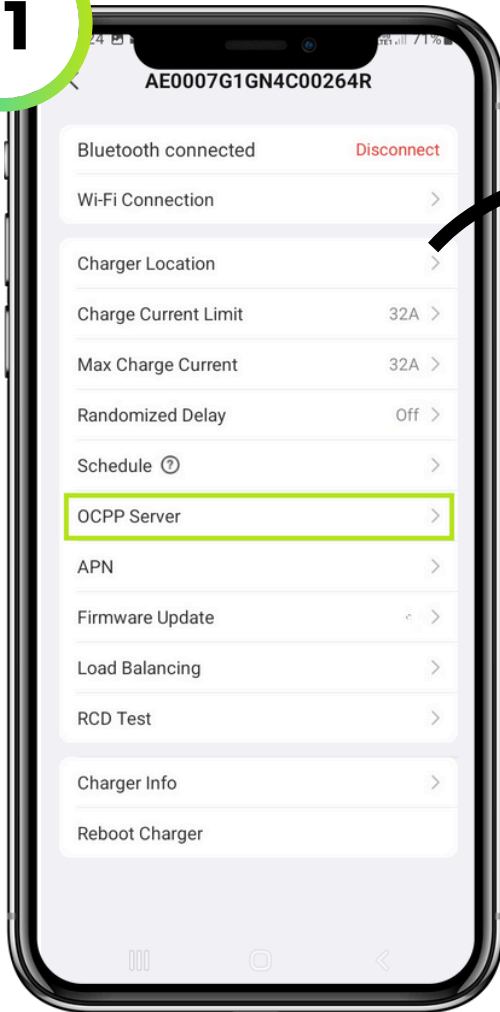

11. On the charge point main menu, select OCPP Server.

12

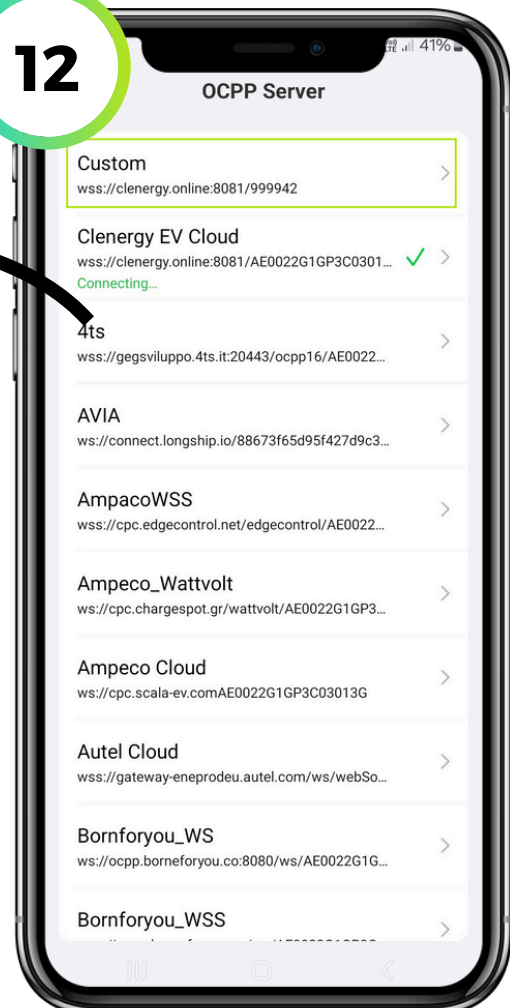

12. Select Custom from the menu.

13

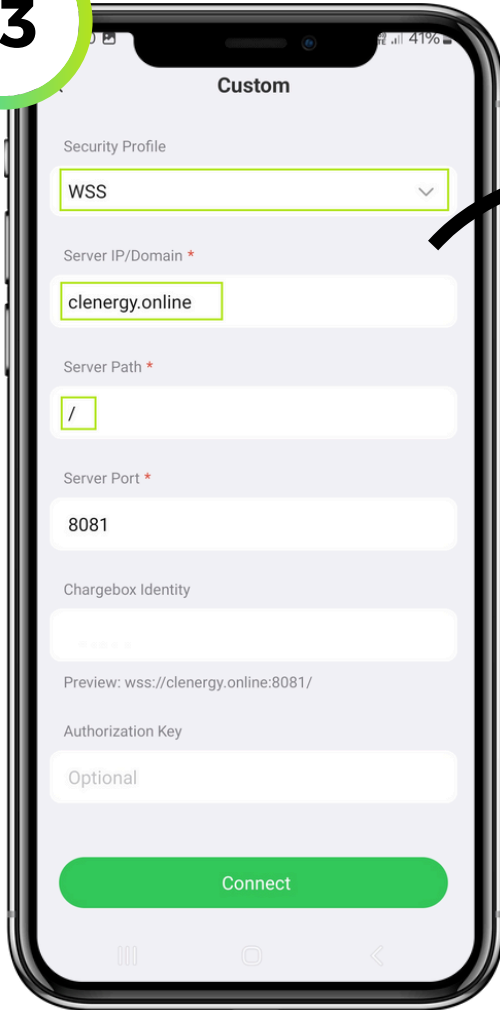

Custom

Security Profile

WSS

Server IP/Domain \*

clenergy.online

Server Path \*

/

Server Port \*

8081

Chargebox Identity

Optional

Preview: wss://clenergy.online:8081/

Authorization Key

Optional

Connect

13. Select WSS from the Security Profile drop-down menu. Enter clenergy.online into the Server IP/Domain field and / into the Server Path field.

14

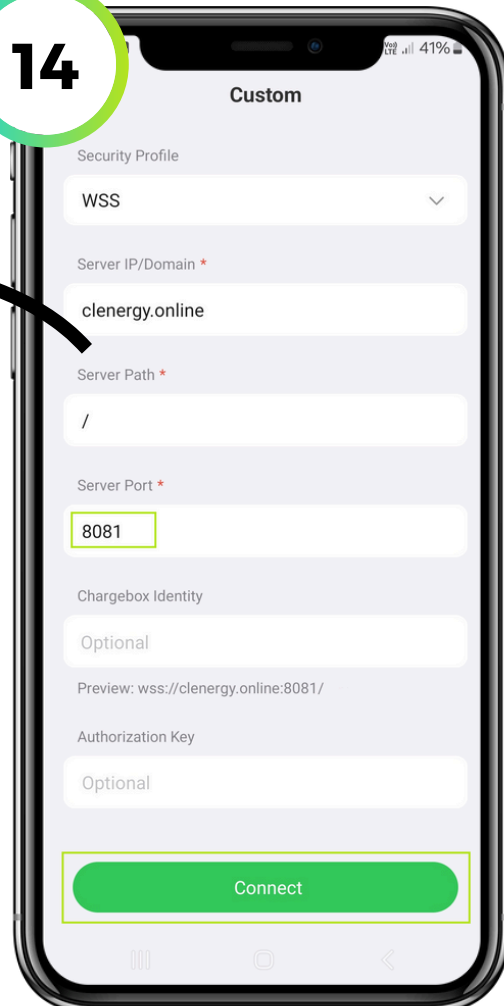

Custom

Security Profile

WSS

Server IP/Domain \*

clenergy.online

Server Path \*

/

Server Port \*

8081

Chargebox Identity

Optional

Preview: wss://clenergy.online:8081/

Authorization Key

Optional

Connect

14. Enter 8081 into the Server Port field and select Connect to proceed.

**Please note:** Leave the Chargebox Identity field empty to allow the charger to connect via its default ID tag (serial number).



15

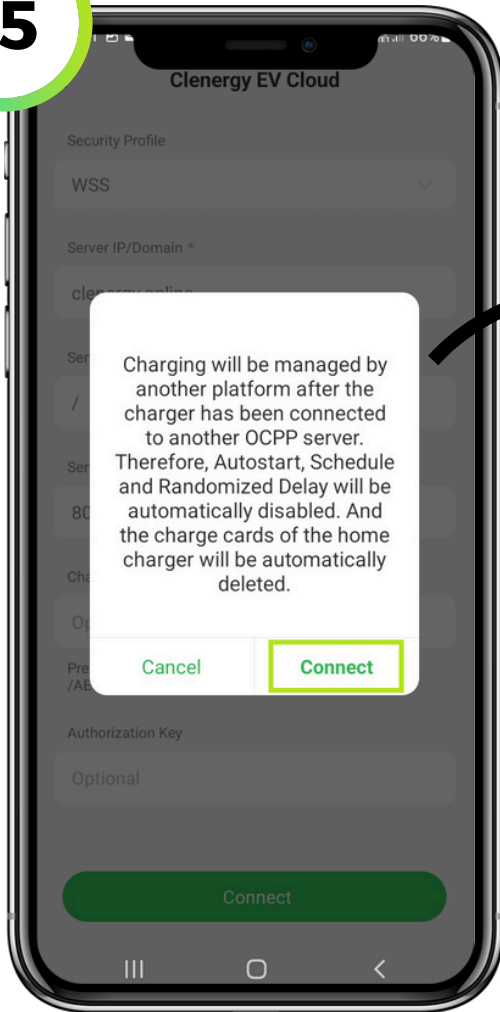

15. Select Connect to proceed.

16

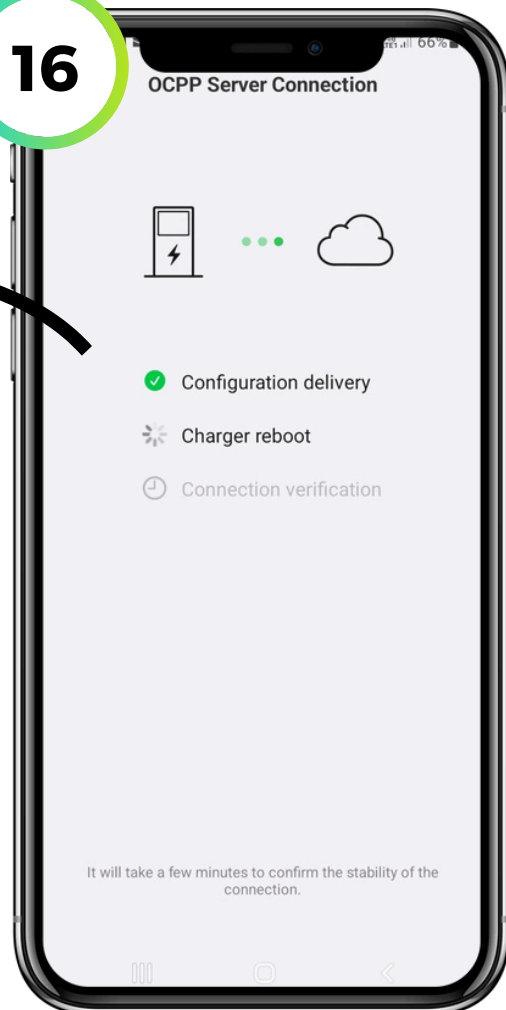

16. Wait for the charge point to apply the configuration and reboot to complete the onboarding process.

**Please note:** If the Connection verification process fails, please disregard this as Clenergy EV needs to finalise the connection to the platform.