



CLENERGY EV

ABB Terra AC Charger - Onboarding Guide

Where to find the TerraConfig App?

By 'TerraConfig' in App or Google play store

*Note:
Previously downloaded TerraConfig App need
to be updated to minimum version 1.3.*

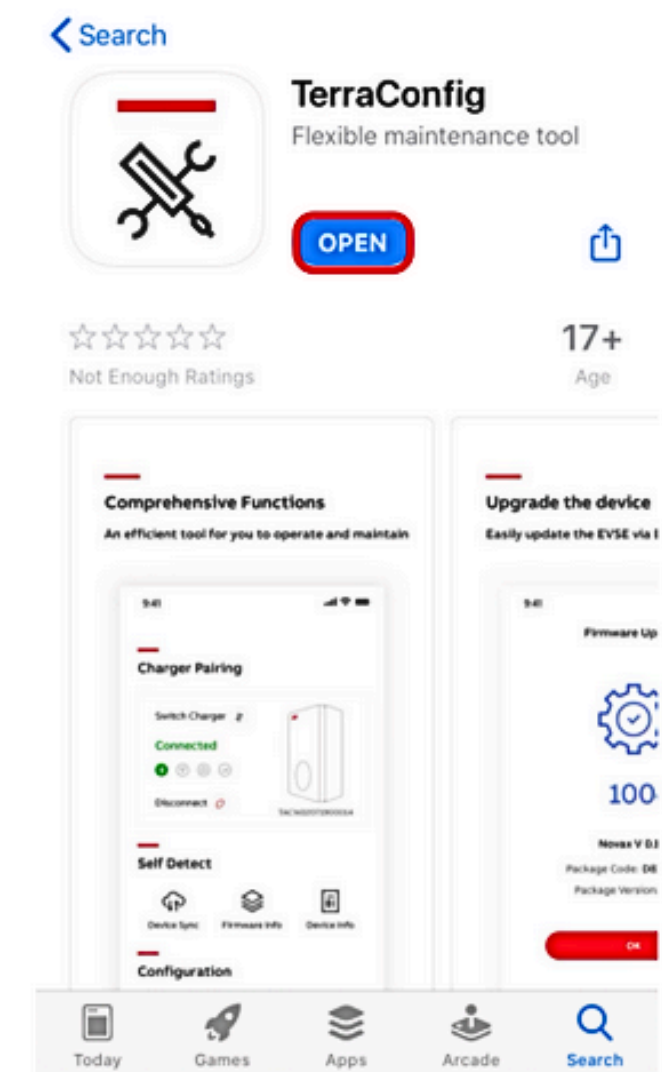
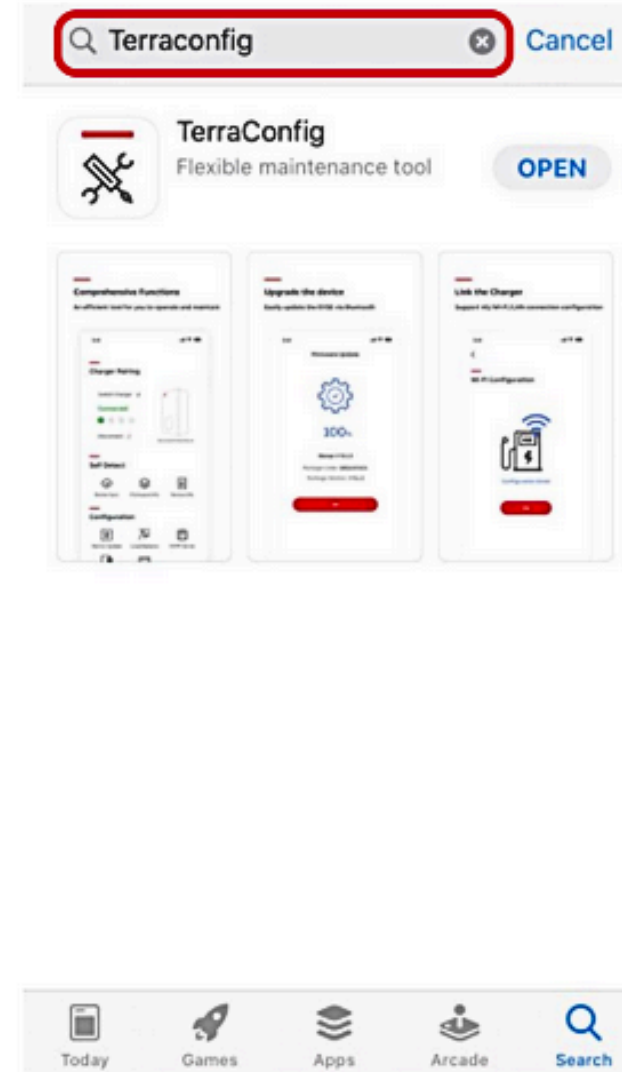

Log in with TerraConfig account

1. Install and open TerraConfig App
2. Log in with credentials received by email **upon account request**
3. Follow the steps to log in. It is advised to change the autogenerated password after the first log in



Activation of your new TerraConfig account

Dear Marouan,

You have signed up for a TerraConfig user account [email address](#)

Please use the original password to log in, change it after first log in.

ME699159

Thank you for using TerraConfig , we are here to start a new experience in experiencing charger installer service.

For answers to frequently asked questions and additional support resources, email us at developer@chargedot.com

Best Regards,

TerraConfig Development Team.

* This is automatically generated e-mail, please do not reply. *

Log in

[Forget your password?](#)

LOGIN

Connect to Charger

1. Smart phone needs to be connected to the internet
2. Bluetooth connection needs to be enabled
3. Press 'Connect Charger' to activate search for charger
4. Select your charger from the Device List by Serial Number
5. Enter the Pin code (letters + numbers) given by Charger owner and press 'Continue'.
6. TerraConfig app will connect to that charger

Note: owner can change the pin code by ChargerSync app



Home screen

Device Update

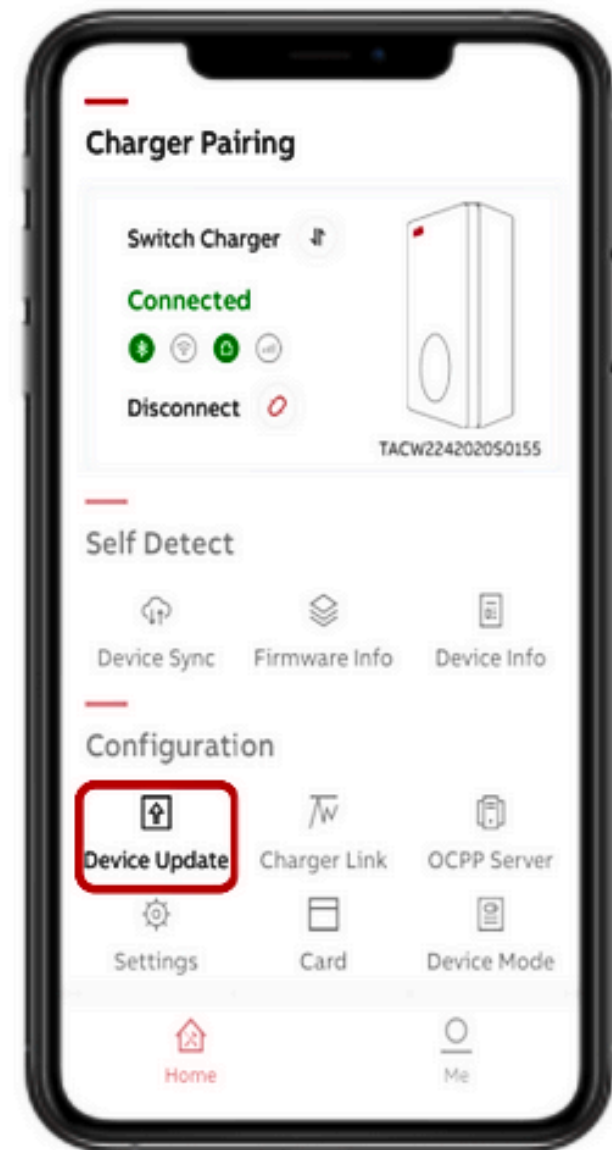

With 'Device Update' the latest firmware or specific version can be downloaded and uploaded to the charger.

Press "+" and the TerraConfig App will search for available Firmware.

Followed by Add Package and Upload Package to the charger.

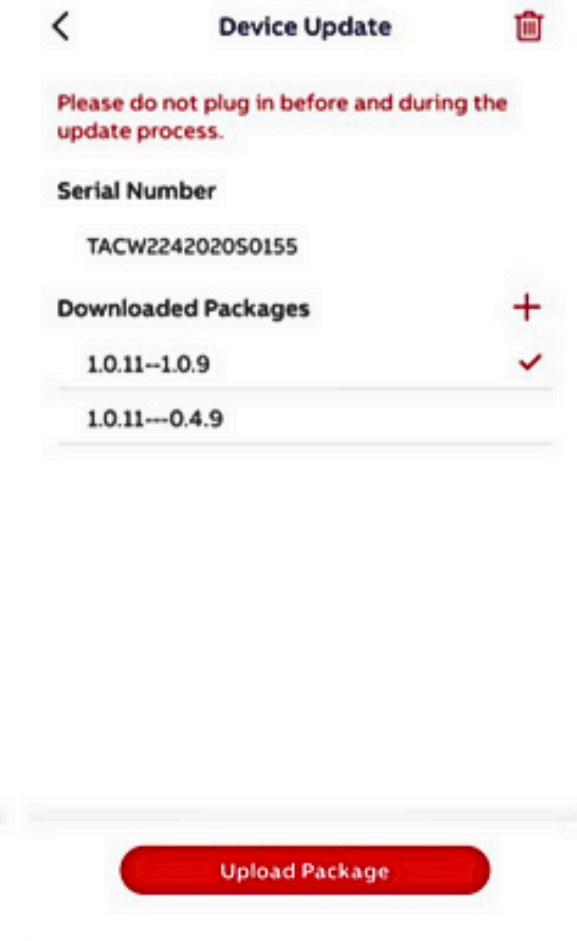

TerraConfig app

Connectivity

Connectivity options

Bluetooth established every time the app pairs with the charger

The app connects with the charger only via BLUETOOTH!

The internet connectivity options for Terra AC are **WiFi, LAN and 4G**

Depending the option, the symbol becomes green – as shown in the following pictures

Offline mode is also possible!
(for the connection led to stop blinking)

Charger Pairing

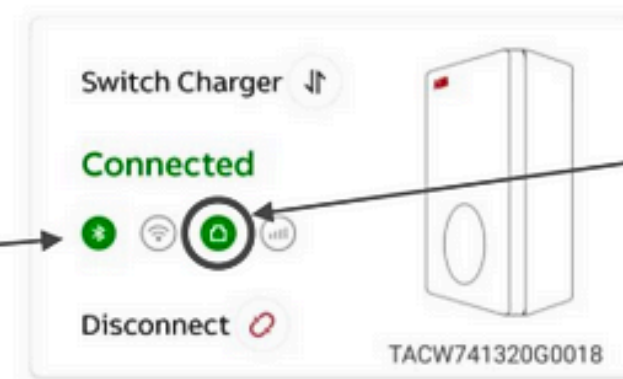

WiFi

Self Detect



Device Sync



Firmware Info



Device Info

Configuration



Device Update



Charger Link



OCPP Server



Settings



Card



Device Mode



Home



Me

Charger Pairing

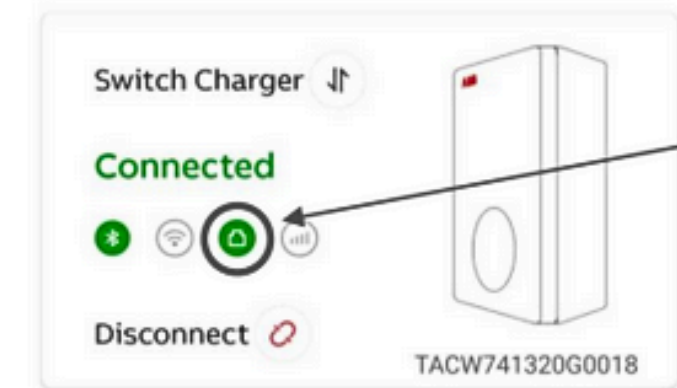

LAN

Self Detect



Device Sync



Firmware Info



Device Info

Configuration



Device Update



Charger Link



OCPP Server



Settings



Card



Device Mode



Home



Me

TerraConfig app

Charger Link options

For a charger to talk OCPP with any backend, it needs to be connected to the internet!

At Charger Link we can see the connectivity options.

Any Terra AC has the following options:

- WiFi and LAN
- 4G type is an extra feature and has to be ordered as one

The image displays a composite of three screenshots from the TerraConfig app, illustrating the 'Charger Link' configuration process. The top-left screenshot shows the 'Charger Pairing' screen for a device with ID TACW741320G0018, which is currently 'Connected'. The bottom-left screenshot shows the 'Configuration' menu with 'Charger Link' highlighted in a red box. The right side of the image shows two 'Charger Link' configuration screens. The top-right screen is for an 'Any Terra AC' model, showing network activation options: Wifi, LAN, and Offline. The bottom-right screen is for a '4G model', showing network activation options: Wifi, 4G, APN Settings, LAN, and Offline. Arrows indicate the flow from the 'Any Terra AC' model to the top-right configuration screen and from the '4G model' to the bottom-right configuration screen.

TerraConfig app

Charger Link 4G

Before configuring the Charger 4G connection insert the m2m nano sim card.

APN settings are necessary!

So make sure you have this information in advance from the 3rd party backend provider

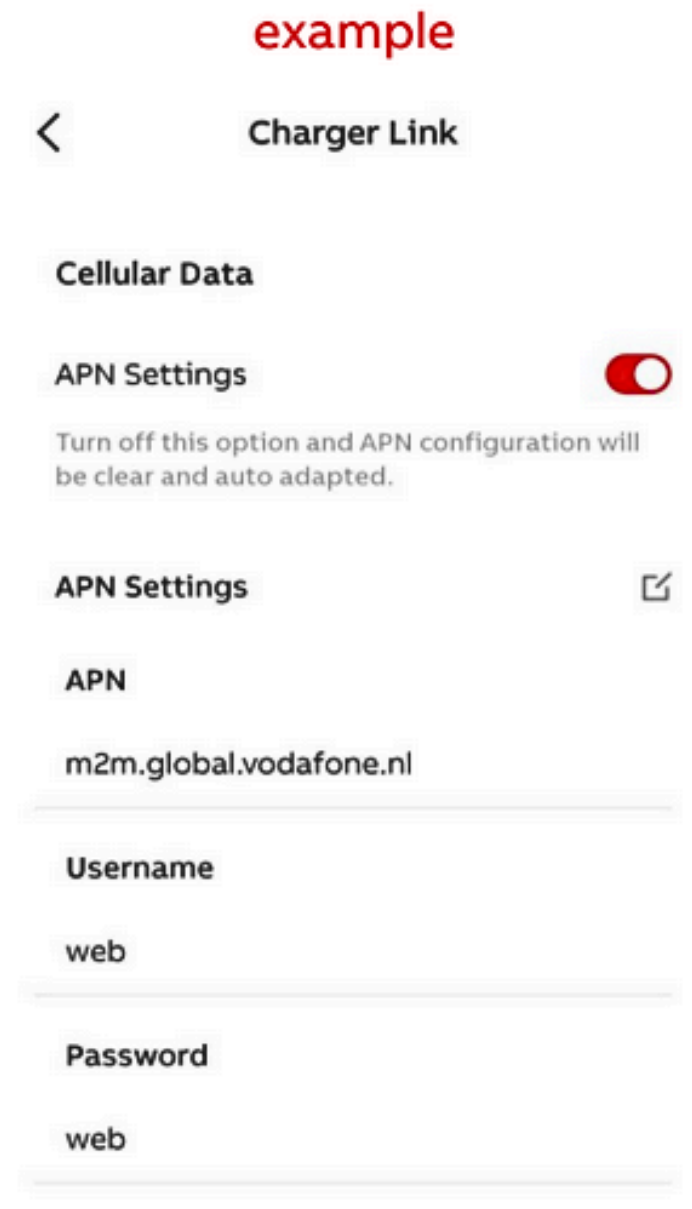
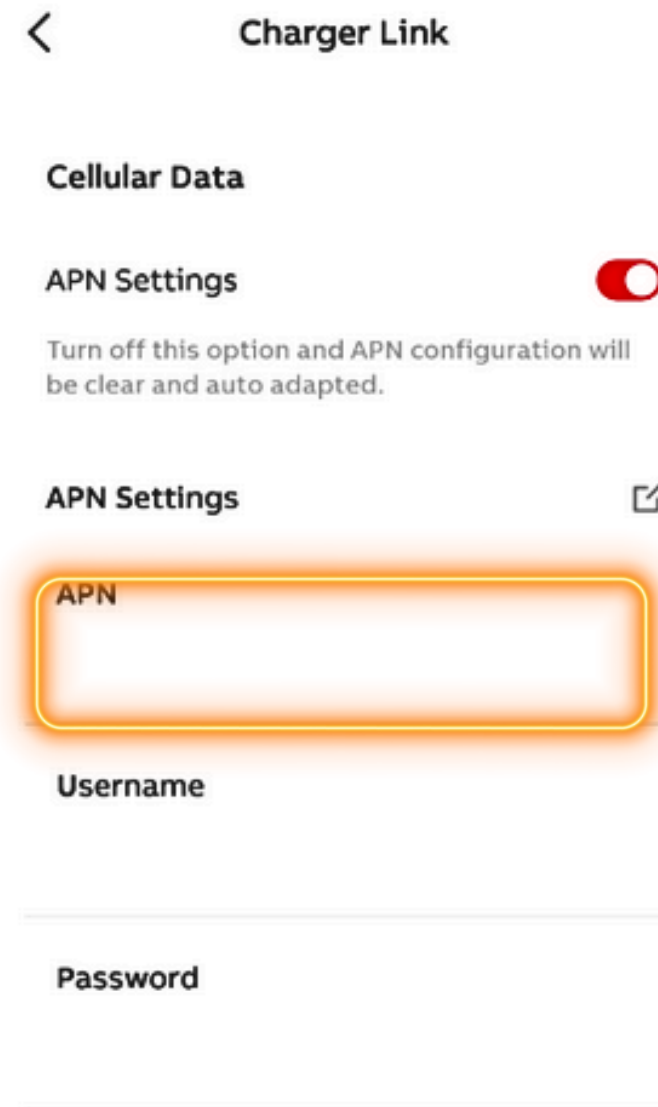
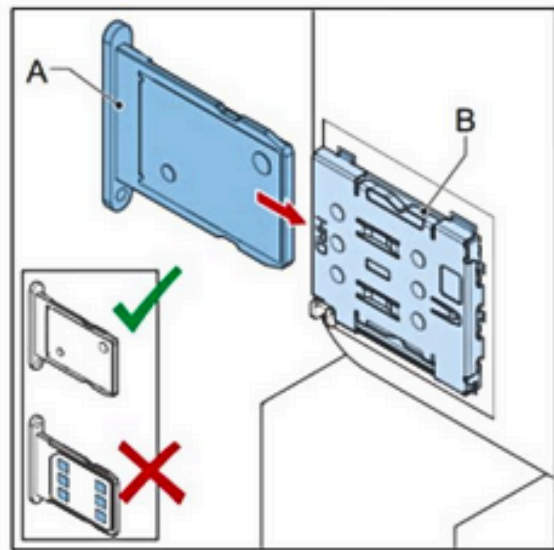

In the "APN" field, please enter the following: **WLAPN.com**

TerraConfig app

Charger Link 4G

Before configuring the Charger 4G connection insert the m2m nano sim card.

APN settings are necessary!

So make sure you have this information in advance from the 3rd party backend provider

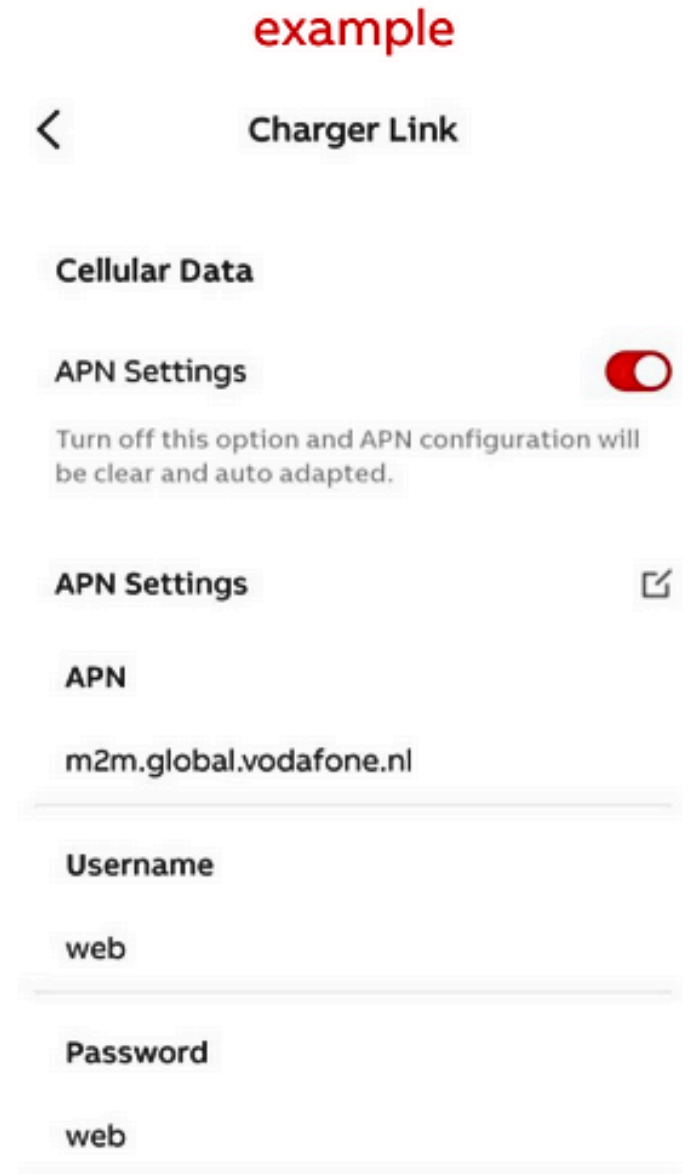
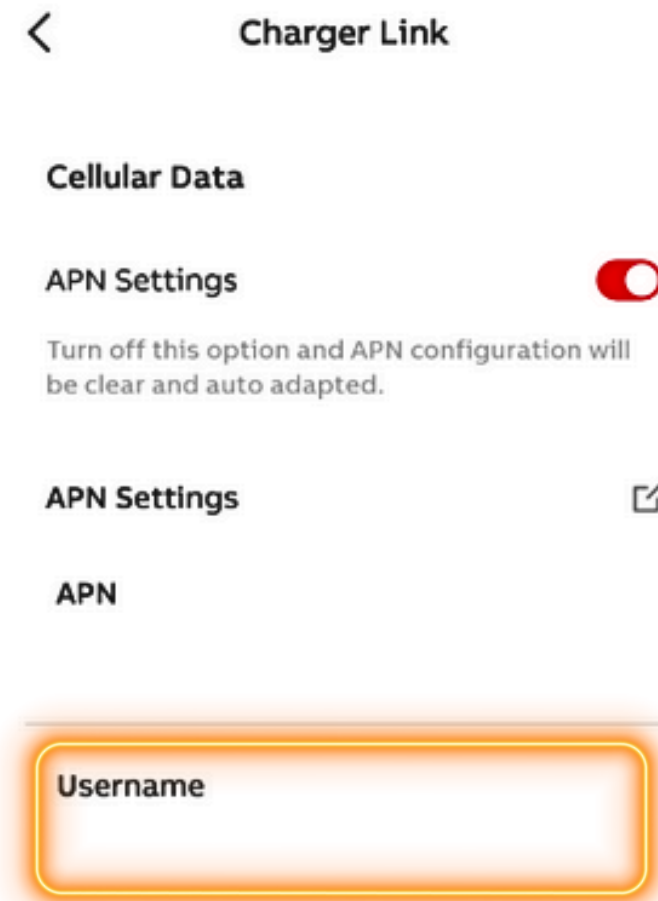
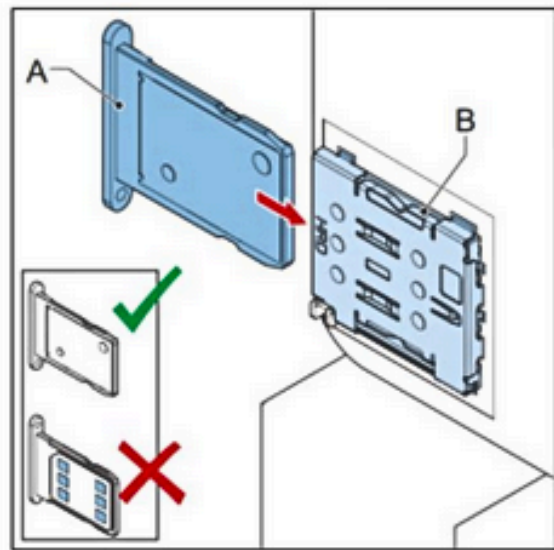

In the "Username" field, please enter the following: **Clenergy**

TerraConfig app

Charger Link 4G

Before configuring the Charger 4G connection insert the m2m nano sim card.

APN settings are necessary!

So make sure you have this information in advance from the 3rd party backend provider

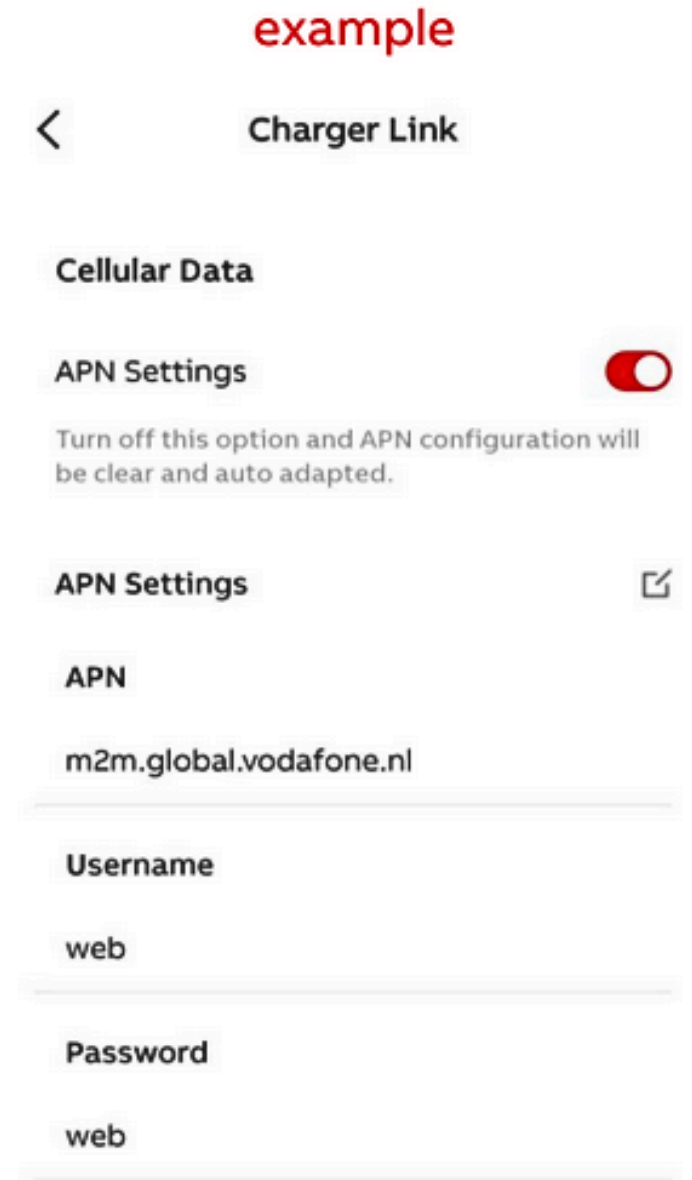
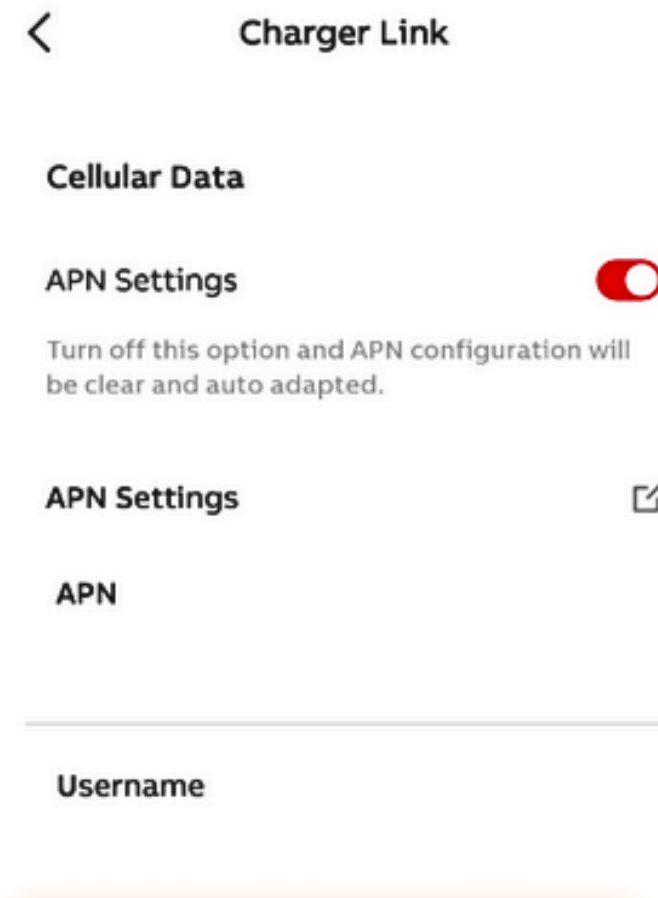
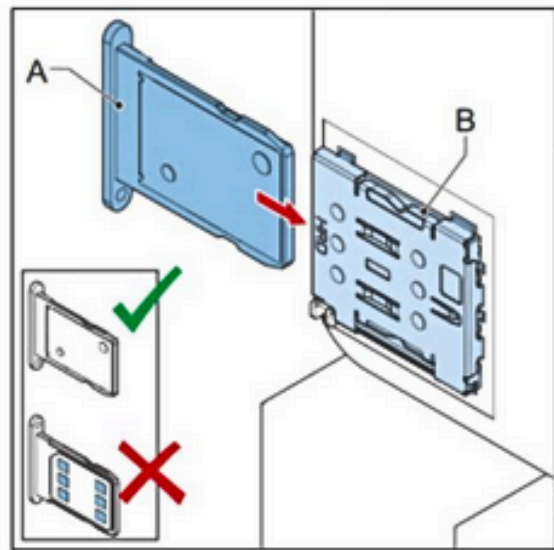

In the "Password" field, please enter the following: **Clenergy**

Home screen

Charger Link WiFi

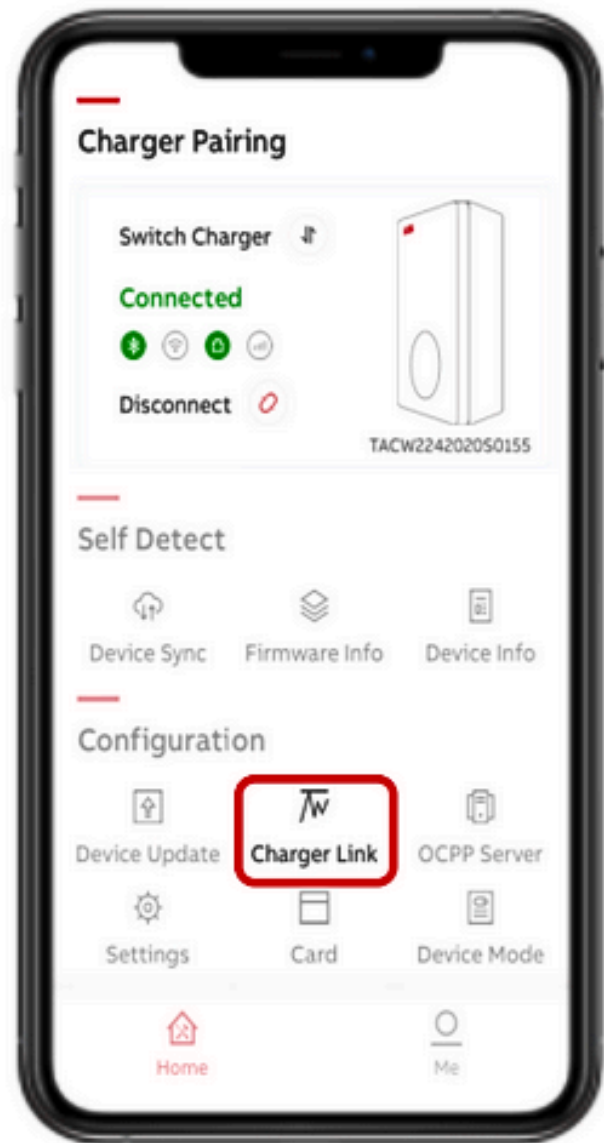

Before configuring the Charger Wi-Fi connection the smart phone needs to be connected to the selected Wi-Fi network first.

1. Enable Wi-Fi and press Wi-Fi Settings
2. SSID shows the connected Wi-Fi network
3. Enter Wi-Fi password and press 'Next'
4. Charger is connected to Wi-Fi network

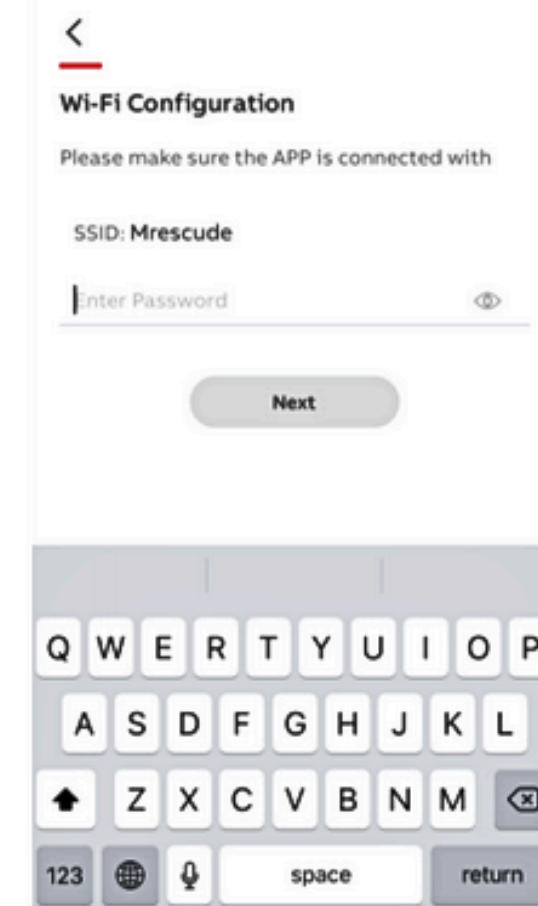

TerraConfig app

OCPP server

In the OCPP server feature you can enable the external access.

More specifically, if you enable it you can connect to another server.

Default setting is the abb.cdlink.chargedot.com

The screenshot displays the TerraConfig app interface. At the top, the word "default" is written in red. Below it, the "Charger Pairing" screen shows a "Connected" status with a green plus icon and a "Disconnect" button. A diagram illustrates the connection between an "Original" server, a "Charger", and an "External" server. Below this, the "Self Detect" section includes "Device Sync", "Firmware Info", and "Device Info" options. The "Configuration" section has "Device Update", "Charger Link", "OCPP Server" (highlighted with a red box), "Settings", "Card", and "Device Mode" options. At the bottom, there are "Home" and "Me" navigation icons.

OCPP Server

Enable this function to allow external organizations to access the EVSE.

Enable external access

Serial Number

TAC2245019S0056

Server Info

testabb.cdlink.chargedot.com:9043 >

TerraConfig app

OCPP server external access

Enabling external access shows a drop-down list of possible URLs to connect to.

This list is the same as the OCPP configuration from TerraConfig web portal account! That is why it is needed to put the configuration in advance in the web portal.

By clicking one of the URLs and pressing OK configure the charger.

options

OCPP Server

Original Charger External

Enable this function to allow external organizations to access the EVSE.

Enable external access

Serial Number
TACW741320G0018

Server Info
ocpp16dev.azurewebsites.net:80

Total: 13 data

- http://hcf123.com
- testabb.cdlink.chargedot.com
- uatabb.cdlink.chargedot.com

Configure

In the "**Server Info**" field highlighted above, please enter the following URL:
https://clenergy.online:8081

TerraConfig app

Device info

Here you can find general information about the Terra AC.

Most specifically, in this case we are interested in the internet connection.

On the server info you can find which backend the charger is connected to.

So please double-check that the charger has established stable connection with the backend.

